

OFFICE BEARERS:

President: Ray De Marco
Vice President: Ian Rudd
Secretary: Graham Ethell
 Telephone 9522 7674
Treasurer: Alan Ritchie
Auxiliary Positions:
Assistant Secretary: Roger Dixon
Assistant Treasurer: Roger Walsh
Project & Training Sub-Committee: Bob Davis,
 Alan Ritchie, David Whitney, Gary Halder,
 Barry Gardner & Ken Tyson.
Librarian: Roger Walsh
Safety Officers: Roger Dixon, Lynn Messenger,
 Alan Ritchie Warwick Tame, Ken Tyson, Ian
 Rudd & Ray Tregoning
Welfare Officer: Peter Mott
First Aid Officers: Graham Ethell & Alan
 Ritchie
Newsletter Editor: Barry Gardner
Assistant Newsletter Editors:
 Ray De Marco & Fred Seligmann
Catering Officers:
 Richard Cain, Trevor Lewis, Lynn Messenger
 & Roger Walsh
Equipment Officers:
 Bob Davis, Alan Ritchie, Roger Dixon, James
 Windschuttle Ian Rudd, & Ken Tyson
Raffles: Peter Mott
Exhibitions Sub-Committee:
 Bob Davis, Malcolm Armstrong, Graham
 Ethell, Fred Seligmann, Ian McRae & Don
 Williams
Property Sub-Committee: Richard Cain, ,
 Graham Ethell, Roger Dixon & Peter Mott
Toymaking: Malcolm Armstrong, Barry
 Gardner, Roger Dixon, Ken Tyson, Steve
 Lansley, Glen Reeve, Reno Scriberras, Fred
 Seligmann & Don Williams
Woodcarvers' Liason: Don Williams

Josie's Table

A Very Special Project

I was given a small but very important request for a purpose built table for a special little girl. Given the circumstances of this request it was perceived as an interesting project and enthusiastically undertaken by our super craftsmen Ian Rudd and Ray Tregoning.

Shown in the image is the small table with folding legs that was built by Ian and Ray. Its design was specifically for the needs of a family who have the little four year old girl called Josie. Josie has a very rare condition called FoxG1 and her condition is one of impaired development from birth. It is complex; Josie is unable to walk or speak and has involuntary movements of her limbs together with a difficulty in learning to sit unaided or without being restrained.

The specific design of the table shows a timber rim as an elevated edge of timber around the laminated table top and has fold away legs. The edge is to help prevent her toys and learning aids falling to the floor caused by



her involuntary movements. The benefit is already being felt as seen with Josie in a poncho playing with a sensory play liquid that would normally be spilt on their floor. The fold away legs assist in storage as she needs more than one table with each one having legs with a different height for her respective seating and to position her closely to the table.

As you can imagine Josie is a precious and beloved family member who brings joy to everyone around her and anything to help her like this table from Ian and Ray is very warmly appreciated by her parents Sara and Scott.

Ray De Marco



**Alcohol is not in
my
VODKABULARY
However, I
looked it up on
WHISKEYPEDIA
and learned if
you drink too
much of it,
it's likely
TEQUILYA!!!**



**Garbage Truck delivery to
Sutherland Shire Council**

Story page 4

**Sydney Children's Hospital,
Randwick Delivery**

Story page 5



From Secretary Graham!

Here is a photo of Richard. The caption could read:
 “What is an Englishman doing with a cake of soap at the Workshop?
 First correct answer on maxi day will win a valuable prize.”



MAXIDAY: SATURDAY 13 August 2016 ... AGENDA

- 8:45am Open Lilli Pilli Workshop
- 9:00am Monthly Meeting
- 9.30am Morning Tea
- 10:00am ANNUAL GENERAL MEETING—see notice on following page
- 10:30am Show & Tell
- 11:00am Picture Mounting including demonstration of Framenco mount cutting equipment
- 12:00noon Lunch
- 1:00pm Demonstration of new Router Table
- 1:45pm Raffle Draw
- 2:00 pm Members own projects
- About 4:00pm Close

An Invitation:

An early reminder to members.

Our PLANK COMPETITION JUDGING takes place at our Club on SATURDAY, 10 SEPTEMBER, 2016

This day is a very special day for our Club and as usual we invite our spouses or partners to participate on the day and join us for morning tea and lunch. Hopefully Chef Richard may put on something special.

Please let Chef Richard know whether you will be attending with your spouse or partner on or before Tuesday, 6 September 2016

If you would like to receive this
 Newsletter please email the editor at
shirewoodworking@bigpond.com
 or if you have an article that you think would be
 suitable for publication in this newsletter your
 Editor should be pleased to receive it.

Raffle Prize Winners

JULY 2016 MAXIDAY

1st Prize:	Doug O'Hara	\$25.00
2nd Prize	Ian Rudd	\$15.00
3rd Prize	Don Williams	\$5.00
4th Prize	Alan Ritchie	

Bottle of Wine

Library Matters

We have received our October 2016 Issue 256 of Fine WoodWorking. Some good reading with following highlights:

On line videos -

For those who took out the online membership some videos – turn your planer/ thicknesser into a jointer, choose the right router bit for the job, how to make a batch of shellac from flakes, double tenons on the bandsaw, beautiful bandsaw boxes

Tools and materials – Bosch's newest 12 inch sliding compound-mitre saw, Router motor by Porta mate, DeWalt 5 inch orbital sander.

Fundamentals – Get started with your plunge router,

Feature Articles – Frame-and-Panel Cabinet, Fast shellac finish, Get better cuts with your planer, Bold joinery using clean attractive through-tenons, Build a simple stool, Make your own bandings,

Handwork – Use of a travisher, The best way to cut dovetails, The mortise-and-tenon joint.

Magazine will be in the library from Thursday 11th August. Happy woodworking.

Roger Walsh, Club Librarian

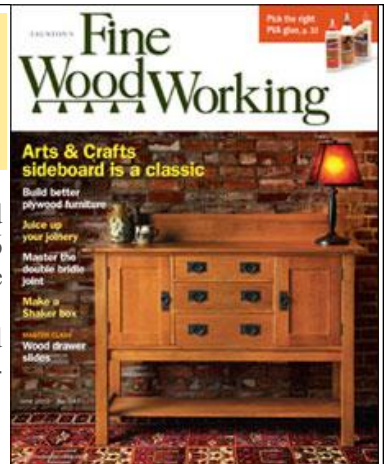



Shire Woodworking Club Inc.

ABN 15 974 163 667

Club Room: 2B Turriell Bay Rd

Lilli Pilli 2229

Postal address: 13 Roma Place

Sylvania 2224

e-mail: gethell@bigpond.net.au

Phone: (02) 9522 7674

NOTICE OF 18th ANNUAL GENERAL MEETING

The Eighteenth Annual General Meeting of the Shire Woodworking Club Inc. will be held

At: The Workshop, 2B Turriell Bay Road, Lilli Pilli 2229

On: Saturday 13 August 2016 at 10.00 am.

AGENDA

1. To confirm the Minutes of the 17th Annual General Meeting held 8 August 2015.
2. To receive the President's Report for the year ended 30 June 2016.
3. To receive the Financial Report for the Club for the year ended 30 June 2016.
4. To elect office bearers for the ensuing year.
5. To consider any other matter which may lawfully be brought to the meeting.

By Order

Graham D. Ethell

Secretary

5 July 2016

WOOD STAIN. Warwick Tame took us on a most informative journey of staining wood at our July Maxiday and advised "My presentation at the July Maxi day was to share some of my techniques with wood staining. The two main stains demonstrated were Watty's English Mahogany, a mineral turps base stain and Feast Watson Proofint, a spirit base stain applied to a variety of woods.

For the demonstration pieces of Pine, Cedar, Oak, and Hardwood each half sealed with a diluted solution of shellac. A mixture of dewaxed blond shellac and alcohol (2lb -cut) and about 10% additional alcohol added. This is to allow for greater absorption into the wood and very little discolouration. There are pre-stain wood conditioners on the market the benefit being the wood will stain evenly especially when using softwoods, etc. will determine how you proceed with staining and the effect you can expect.

There are various points of view on how smooth the wood should be prior to applying the stain. I sanded all the demonstration pieces up to 220grit. The theory being the lower the grit the rougher the wood will be and more stain will absorb into the wood creating a darker finish. The opposite, the smoother the wood less absorption resulting in lighter stained piece.

A couple of important items before you commence staining. Ensure the surface to be stained is free of dust and debris by wiping down with a damp cloth (I prefer a cloth soaked with a small amount of methylated spirits) put your rubber gloves on and make sure the stain is stirred well. Application of stain can be either by brush for large or fiddly jobs or a lint free cloth. Follow the manufactures instructions."

Many thanks Warwick. Ed.



On Friday 22nd July Warwick Tame and I made a special visit to the Sutherland Shire Council premises to present on behalf of our Club a very high quality, detailed and scaled timber garbage truck. Warwick was the member who built the truck and considering this detail, finish and time spent, he graciously donated the truck to our club. It was then considered and agreed to by Warwick that this would be an ideal way for us to present the truck to Council to express our appreciation for all the friendship and support extended to us over the last few years.

On arrival we received a very warm welcome from David Ackroyd, Manager Communities Unit (who is well known to our Club) and this was similarly extended to us when we went upstairs to meet Carmelo Pesce the Mayor (Carmelo has previously visited our workshop). Carmelo's staff and Councillor Tom Croucher also spent time with us and gave Warwick an opportunity to explain how he made the detailed suspension, wheels, loaders and the simulated mechanisms.

With Carmelo, David and Tom we went back to the front courtyard entrance of the Council's premises and to our surprise we were introduced to the two operators who had just arrived with one of the Council's newly acquired garbage trucks. It was a good initiative by David as an opportunity for them to meet Carmelo his staff and us.

This gave the Council a great opportunity for an interesting "photo shoot" for their photographer and shown here are just two of a number of high quality images taken in the morning.

We then went back upstairs and spent time in Carmelo's office with David over a coffee to discuss a number of relevant matters related to the Council and our Club. Warwick and I were very impressed with the morning in their company to experience the friendship extended to us by Carmelo, David and staff in a relaxed and appreciative manner.

Ray De Marco



Photo by Gerard McDonough



Photo by Gerard McDonough



Photo by Gerard McDonough



Photo by Gerard McDonough



Photo by Gerard McDonough



Friday 22 July saw Malcolm chauffeur Lyn, Glen, Steve and Barry to the Sydney Children’s Hospital, Randwick with some 217 items for the Child Life and Music Therapists. They are most grateful for our contributions to their work with the young patients in their care.

A few things to report.

- The cot frames now, no doubt, will be on the wards hopefully working successfully. We will get a report back in about a months time as to whether they are working well or need some strengthening in some area.
- Apparently the Oncology Ward have a board type game that includes wooden snail markers. Because of their size they tend to get lost. They have one snail marker left. It is currently in our possession. This means the game that general has up to six snail markers is not much use. Glen has taken on the task of producing a couple of dozen or so. Happy snail cutting Glen.
- The Music Therapists “Click Stick” stocks are getting low. So if we have any spotted gum in our timber stocks we should save it for these. A member looking for something to do then the cutting of these “Click Sticks” is a job waiting to be done.



The list of items delivered to the hospital included

4	Large High sided trucks	2	Seal Puzzles
4	Flat Top Block Trucks	4	Steam Engines
4	Small Flat Top Block Trucks	8	Electric Guitars
2	Block Cars	15	Star Wands
2	Racing Cars	14	Boomerangs
17	Keepsake Boxes	14	Play Dough Rolling Pins
2	Worry Boxes	7	Vases
2	Music Clackers	4	Rocking Bears
5	Bangles	9	Cut Out Puzzles
3	Echidna Puzzles	7	Cot Frames
9	String Leg Football players	3	A4 Hope Trees
25	Owl Boxes	3	Push along Ducks
1	Penguin Puzzle	3	Bi Planes
2	Dolphin Puzzles	4	Mobile Phone Rests
3	Horse Pen/Jewellery Trays	6	Dog Pen/Jewellery
1	Crown Pen/Jewellery Trays		
4	Doll Rooms with 24 Furniture pieces.		

**Charitable Toy & Item
delivery count for
2016 to date
424**

A NEW EDITION TO OUR WOODWORKING MACHINERY

Our Club has taken delivery of a new Router Table (the same as pictured) to replace one of our Triton Router Tables that have served us masterfully for almost 18 years.

This new table is the top of the range table from “Baladonia Tools”. It includes and is described as

- ◇ “810x610mm table is cast and precision CNC-machined multiple times so they are dead flat as well as having the standard 3/4in mitre track and 5/16in t-track slots milled parallel to the mount aperture in the table. The table has been designed with stress relieving and strengthening ribs in the underside of the table to ensure minimal movement over time and maximum strength. The cast-iron tops are cast and precision milled by one of the premier OEM manufacturers of machinery in the world. They even take the extraordinary step of not casting the tables over winter as the reduced ambient temperature affects the quality of the material. They take every step possible to make sure you get the best of the best. It is super-flat and square with every dimension checked to micrometer accuracy in every way so you don't have to wonder about any components lining up - they all fit together neatly and accurately so you can start routing sooner. You will not find a better quality table top in any router table – guaranteed!
- ◇ The stand to suit the 810x610mm (32x24in) cast-iron table is the ultimate base for the ultimate cast-iron top. The posts are manufactured from heavy tubular steel with thick steel braces that provide a rock-solid base for the heavy-duty top. It comes standard with the remote switch and mitre guide as well as handy built-in router bit organizers on the sides and retractable wheel kit.
- ◇ The mount plate aperture measures 305x230mm and the Router Lift mounted into it. The lip around the edge of the mount plate recess has eight self-leveling adjustable screws to adjust the platform that the plate sits on to make sure it is dead-flat with the smooth and flat cast-iron table top.
- ◇ Switch and Mitre Guide and gauge
- ◇ Solid Flat Fence
- ◇ Four post router lift
- ◇ Dust collection box able to be connected to the Clubs Dust Extraction System
- ◇ 2 horizontal and 2 vertical featherboards
- ◇ Fence Flip stop
- ◇ Router Bit storage
- ◇ Mobile with braking lift system
- ◇ The system takes our current Triton Routers.

There was a small problem with the Router Table when it was assembled. That was the limited room the dust box allowed for operating our Triton Router being our preferred router for use in this new table. It was a known potential problem when the table was being reviewed and at one stage it was considered that we would not purchase the dust collection box. However we did and with the collective genius of Roger D, Ian R and Ray T they used the fittings from the supplied dust collection box in one they built from scratch and for good measure added a much needed drawer to house spares etc for the table and the router.

It is now also connected to our Dust Collection System thus alleviating another problem with the Triton Router tables and that is getting rid of the router shavings.

Many thanks to Roger, Ian and Ray and we look forward to a demonstration at our forthcoming August Maxiday.



imb BANK
**COOK
 COMMUNITY
 CLASSIC**

SUNDAY 20th NOVEMBER 2016
 CRONULLA PARK & BEACH

\$2 per ticket
 \$20 per book

Charity Raffle - 5 fantastic prizes!

- 1ST PRIZE** FLYING QANTAS. Two return Premium Economy class flights from Brisbane, Melbourne or Sydney to Los Angeles. Donated by QANTAS.
 \$1,000 spending money. Donated by McDonald's Sutherland Shire Restaurants.
- 2ND PRIZE** The Ultimate Westfield Miranda Dining Experience at Mejico, The Italian Kitchen, Braza Churrascaria, Din Tai Fung or Kazbah. Valued at \$1000. Donated by Westfield Miranda.
- 3RD PRIZE** Weekend getaway to Caves Beach for two people + \$500 spending money.
- 4TH PRIZE** \$500 Westfield shopping vouchers. Donated by Westfield Miranda.
- 5TH PRIZE** Apple iPad mini WIFI 16GB Space Grey. Donated by Storage King Kurrajong.

Visit www.cookcommunityclassic.com.au for more details

100% of proceeds from the IMB Bank Cook Community Classic raffle benefit various participating not-for-profits, community groups, P&C's & sporting clubs operating in the Sutherland Shire. Details of organisations can be viewed at www.cookcommunityclassic.com.au or on Facebook. The organisation selling any given ticket is the beneficiary of that sale.



*For full information and terms and conditions please refer to www.cookcommunityclassic.com.au

In need of a parliament of OWLS!

Following from our delivery to the Sydney Children's Hospital, Randwick as reported on page 5 it appears that the "IN" animal for the children is currently Owls.

Obviously our Owl boxes are a great hit with the children of all ages. Where can we spread the owl theme to? Maybe Owl Jigsaw Puzzles, Owl shapes and characters. The following photos may help to get your creative juices working.



A CHALLENGE FOR OUR MODEL MAKERS

Geoff Tong sent a series of photos to your Editor, one of which is seen below, and suggested it may be a challenge for our model making members.

INTERIOR

- Door panels and window shades of embroidered silk, with silk tassels
- Silver and ivory door fittings
- Passenger footrest conceals full picnic set and china tea service for four, plus set of six decanters
- Luxury fabric seat covering

EXTERIOR

- Built by former royal carriage-makers Barker's of Mayfair. Distinctive design echoes luxury Pullman railway carriages of the era
- 29 bevelled glass windows, with wooden frames
- Inflatable tyres
- Original headlights, rear lights and carriage lights
- Private registration number, 1912 RR

THE CONTROLS

- 1 Bahalite steering wheel
- 2 Choke - alters air and fuel flow to engine
- 3 Ignition - controls spark to engine by pulling up or down
- 4 Handbrake, with gear lever (5) next to it
- 6 Hand throttle - known as 'The Governor'
- 7 Fuel gauge

ENGINE

- 7.3-litre engine with 60mph top speed
- Four-speed gear box. Chassis number 1907
- 50 brake horsepower

See you on Toymaking Day 25 August.

SHOW & TELL JULY 2016



Malcolm presented this cutting board holder and advised “In our kitchen we had some cutting boards stored near our cooktop for convenience, but they often slid down and onto to a potentially hot area so I thought of a method to keep them upright! Hence the idea of the rack; wide enough to take a couple of boards.

The rack comprises two side panels, a floor, and ‘stopper’ at the end which is half the height of the panel with the apple motif. The construction is rebated and glued, with the side panels rounded off. The floor was made with a slight gradient away from the opening to prevent our round cutting board from rolling out onto the kitchen floor. The rebate for the floor of the rack was made on the router table on a sled to achieve the sloping rebate (thanks to Alan for his advice!)- it was a bit of a challenge to set up the router table (for me anyway!). The idea was to mount the rack onto the side wall of the pantry to avoid taking up bench space so the left hand panel of the rack was made higher; in the end we just left it as a bench top rack. I added the apple motif to give an aesthetic appeal! The rack is made from some Tasmanian Oak I had under the house; the finish was made with Feast Watson Sanding Sealer; F & W Golden Oak stain and finished with F & W wipe on satin polyurethane.”

1 Sheet of Plywood + 8 lengths of floor boards = 2 Adirondack Chairs

Ray presented these two chairs and advised “Approximately 15 years ago we received 2 x plastic Adirondack Chairs that, due to weathering, had deteriorated and we were concerned they might collapse under us. Gayle researched and found the plans by Norm Abram, of “New Yankee Workshop” and “This Old House” fame. The plans sat quietly in the garage until I did a swap of form ply used for the Club’s recently constructed shed for a sheet of 2400mm x 1200mm x 25mm waterproof plywood.

Doing my calculations I would have been short to make 2 chairs, so I used some of the red gum flooring donated to the club as contrast. I used the contrasting colours adding inlaid strips and plugs for a decorative effect. The chairs are held together by hand-cut dowels, some dominos and Titebond III (no metal fixings). The finish is Feast Watson Outdoor Furniture Oil – Clear.

As usual I changed the design a bit because it didn’t work for me. The plans, being American, were Imperial 1” grid system. They are a beautiful addition to our verandah. I have already spent many hours looking over our water view.”



Malcolm also presented these planes and advised “P38 Lightning WW2 fighter”:

These were made from plans purchased from Toymaking-Plans.com

Material used was the club’s red cedar and some ‘other’ more robust hardwood. There are 22 items in each plane which is quite time consuming; I had to turn wheels, (axles for the two booms), and the propeller spinners as the plans required these items to be off the shelf from a US hobby supplier. Turning small wheels 19mm diameter by 6mm was a challenge. The assembled model was painted with water based acrylic and the decals were provided in the plans and printed out on an ink jet printer then sealed with a spray on matt sealer (to stop the ink running) and glued/sealed with Mod Podge. Final finish was a few coats of acrylic polyurethane clear. Hopefully they can be sold at the next market day, perhaps as a model rather than a toy.”

2016 Plank Competition

28 DAYS TO COMPLETE YOUR MASTERPIECE.

PLENTY OF TIME!

JUDGING

10 SEPTEMBER, 2016

Your Editor wishes to thank Roger Dixon for his assistance, a number of photos and the organisation of some of the stories in this edition due to your Editor’s grandparenting duties in Queensland.

SHOW & TELL JULY 2016



Gary following on his vehicle manufacturing for the Children's Hospital has turned his hand to a bit of woodturning showing us a pen, razor and keyring.



Roger Stephens presented two items, firstly the cutting board shown at left and the Cheese Board pictured in its full usable glory below.

Roger advised "The cutting board is a basic end grain design, 455 x 335 x 25mm thick. Board and edging all made of solid oak."

Roger gave us some design measurements for the cheese board as follows and advised "Designed to provide an accessible raised area for presenting the cheese for cutting, together with lower area for the grapes and biscuits. The initial blank block was



The member for Tahmoor, Jan, presented these two turned items

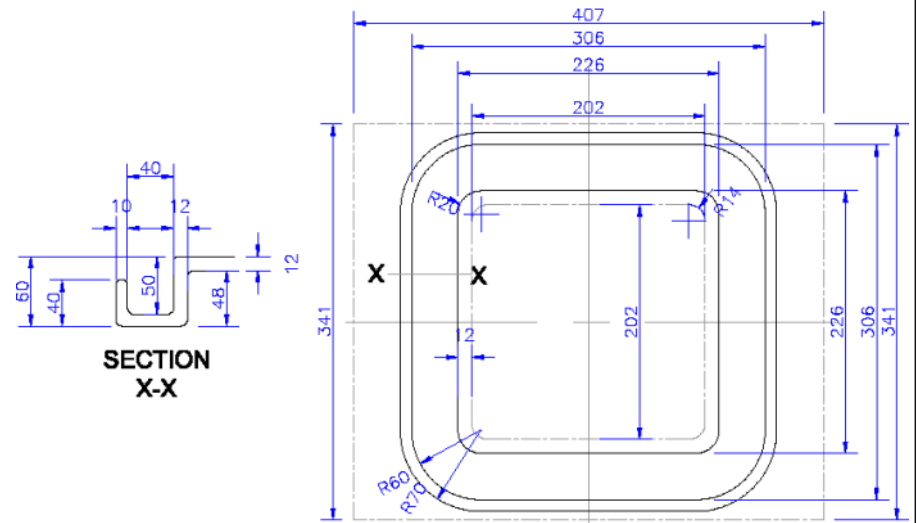

FOR YOUR NEXT STAIRCASE DESIGN



made by gluing together 21 wood strips 40.7 x 34.1 x 6.5cm, Ian Rudd thinks its New Guinea Rosewood." The following photos were also provided with respect of the considerable routing needed.



Template positioned to rout second half of the top. You can see the prior rough cutting a Forstner Bit



Underneath

PRESIDENT'S REPORT

As our member skills are continuing to grow there is a demand on some of our equipment together with the need for flexibility and accuracy in their output. So, at the end of July we received delivery of a new router table and stand. This new tool, labelled a BALADONIA is a precision, performance router with a quality cast iron table top, a stand on castors and comes with a range of accessories that our members will need today and in the future.

What is important however is the recognition of three of our members namely, Ian Rudd, Ray Tregoning and Roger Dixon who made the recommendation for this purchase. They did spend a lot of time in discussion and in research over a period of time looking at various models to finally visiting the Wood Show in June. Interestingly, the "business case" recommendation of theirs and in view of a higher outlay than we all expected it was nevertheless still favourably accepted as the best acquisition for our Club.

Additionally, they assembled and adjusted the unit with Ray re-making an air-box to enable us to install and use our Triton router. I have not had a chance to use the router but looking at it in use and in discussion over the table it has all the features we need. For example, a table top winder, a number of fine adjustments on the quality fence, an excellent quality cast iron top with two mitre channels, good dust extraction and it is very stable with the retractable castors. Thank you Ian, Ray and Roger we appreciate your commitment.

At this point I am pleased to advise that we are at an early stage in investigating the replacement of our very "tired" kitchen. It is in sad need for a changeover for reasons of hygiene, improved storage and increased functionality with our increasing member and community attendances. Again I would like to recognise the same three namely Ian, Ray and Roger who are looking at us removing and installing the kitchen with a flat pack approach. Ian has kindly prepared the specifications and produced an excellent design for looking at the right provider of the pack and to estimate costs. Thank you again to Ian, Ray and Roger.

Lastly, we have our Plank Competition next month so a second reminder for those who have not taken a plank or Club timber to please consider entering an item. Also, to those who have taken one please have an entry ready. We all look forward to some varied and creative items. *Ray De Marco*

Saturday, 13 August, 2016

MAXIDAY

PICTURE MOUNTING. How to mount that oil painting to bring out its highlights.

ANNUAL GENERAL MEETING

DEMONSTRATION of New Router Table

Tuesday, 16 August, 2016

Club Day, Lilli Pilli Workshop

Wednesday, 17 August, 2016

9:00am Club Day, Lilli Pilli Workshop

7:00pm Woodcarvers meeting

Saturday, 20 August, 2016

Club Day, Lilli Pilli Workshop

Tuesday, 23 August, 2016

Club Day, Lilli Pilli Workshop

Wednesday, 24 August, 2016

Club Day, Lilli Pilli Workshop

Thursday 25 August, 2016

Toymaking, Lilli Pilli Workshop

Tuesday, 30 August, 2016

Club Day, Lilli Pilli Workshop

Wednesday, 31 August, 2016

Club Day, Lilli Pilli Workshop

Saturday, 3 September, 2016

Woodcarvers meeting

BUNNINGS BBQ

Tuesday, 6 September, 2016

Club Day, Lilli Pilli Workshop

Wednesday, 7 September, 2016

Club Day, Lilli Pilli Workshop

Saturday, 10 September, 2016

MAXIDAY

PLANK COMPETITION JUDGING DAY.

Tuesday, 13 September, 2016

Club Day, Lilli Pilli Workshop

Wednesday, 14 September, 2016

Club Day, Lilli Pilli Workshop

Saturday, 17 September, 2016

Club Day, Lilli Pilli Workshop

Tuesday, 20 September, 2016

Club Day, Lilli Pilli Workshop

Wednesday, 21 September, 2016

9:00am Club Day, Lilli Pilli Workshop

7:00pm Woodcarvers meeting

Saturday, 24 September, 2016

Club Day, Lilli Pilli Workshop

Tuesday, 27 September, 2016

Club Day, Lilli Pilli Workshop

Wednesday, 28 September, 2016

Club Day, Lilli Pilli Workshop

Thursday 29 September, 2016

Toymaking, Lilli Pilli Workshop

NOTICE TO MEMBERS
Your
2016-2017
Subscription
is now due.
\$30.00

Treasurer Alan Ritchie will be only too pleased to accept your Subscription.

AUGUST MAXIDAY
THEME.

MOUNTING YOUR PHOTOS INTO THAT PICTURE FRAME USING THE "FRAMECO MAT MASTER SYSTEM"

Glen Reeve and Barry Gardner will lead us through this interesting field of enhancing the works of art that you wish to frame.

